

RECEIVER

Type SD-1
DC Resistance (Ω) 135 \pm 15
AC Impedance (Ω) 150 \pm 30
Sensitivity (dB) 115 \pm 2 at 1mW
Frequency Range (Hz) 200-4000
THD < 3%
Operating Temperature ($^{\circ}$ C) -20-+55
Weight (g) 39

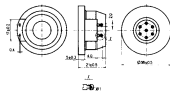

Type SD-2
DC Resistance (Ω) 135 \pm 10%
AC Impedance (Ω) 150 \pm 20%
Sensitivity (dB) 112 \pm 2 at 1mW
Frequency Range (Hz) 300-3400
THD < 3%
Operating Temperature ($^{\circ}$ C) -10-+40
Weight (g) 18

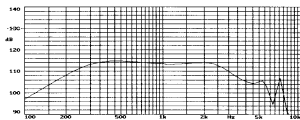
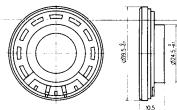
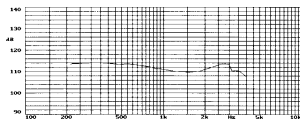

Type SD-3
DC Resistance (Ω) 30 \pm 10%
AC Impedance (Ω) 32 \pm 20%
Sensitivity (dB) 116 \pm 3/-1 at 1mW
Frequency Range (Hz) 100-5000
THD < 2%
Operating Temperature ($^{\circ}$ C) -20-+40
Weight (g) 1

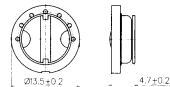
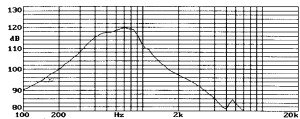

Type SD-4
DC Resistance (Ω) 14.5 \pm 10%
AC Impedance (Ω) 16 \pm 20%
Sensitivity (dB) 113 \pm 4 at 1mW
Frequency Range (Hz) 200-4000
THD < 2%
Operating Temperature ($^{\circ}$ C) -20-+40
Weight (g) 2

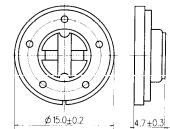
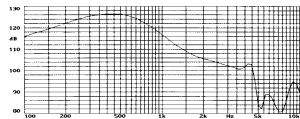

RECEIVER



Type	SD-5
DC Resistance (Ω)	135 \pm 10%
AC Impedance (Ω)	150 \pm 20%
Sensitivity (dB)	108 \pm 3 at 60mV
Frequency Range (Hz)	200-5000
THD	< 2%
Operating Temperature ($^{\circ}$ C)	-10-+40
Weight (g)	1

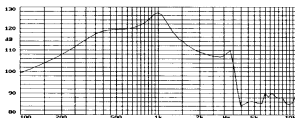

Type	SD-6
DC Resistance (Ω)	90 \pm 10%
AC Impedance (Ω)	100 \pm 20%
Sensitivity (dB)	105 \pm 3 at 60mV
Frequency Range (Hz)	50-5000
THD	< 2%
Operating Temperature ($^{\circ}$ C)	-10-+40
Weight (g)	6

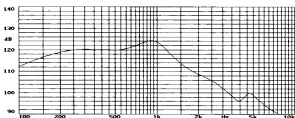

Type	SD-7
DC Resistance (Ω)	30 \pm 10%
AC Impedance (Ω)	32 \pm 20%
Sensitivity (dB)	102 \pm 2 at 1mW
Frequency Range (Hz)	200-4000
Operating Temperature ($^{\circ}$ C)	< 3%
Weight (g)	-20-+40 2.2

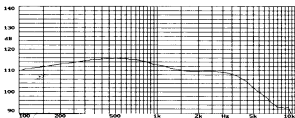

Type	SD-8
DC Resistance (Ω)	135 \pm 10%
AC Impedance (Ω)	150 \pm 20%
Sensitivity (dB)	96 \pm 3 at 100mV
Frequency Range (Hz)	300-3000
THD	< 2%
Operating Temperature ($^{\circ}$ C)	-40-+60
Weight (g)	7

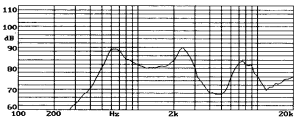

RECEIVER

Type **SD-9**
 DC Resistance (Ω) 135 \pm 10%
 AC Impedance (Ω) 150 \pm 20%
 Sensitivity (dB) 88 \pm 3 at 60mV
 Frequency Range (Hz) 300-3000
 Operating Temperature ($^{\circ}$ C) \leq 3%
 Weight (g) -20-+55
 2.5

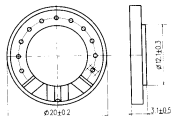
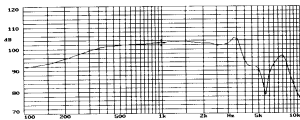

Type **SD-10**
 DC Resistance (Ω) 135 \pm 10%
 AC Impedance (Ω) 150 \pm 20%
 Sensitivity (dB) 91 \pm 2 at 60mV
 Frequency Range (Hz) 300-3400
 THD \leq 2%
 Operating Temperature ($^{\circ}$ C) -25-+65
 Weight (g) 5

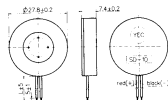
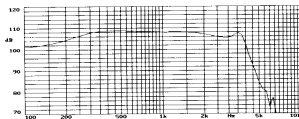

Type **SD-13**
 DC Resistance (Ω) 30 \pm 10% 184 \pm 10%
 AC Impedance (Ω) 32 \pm 20% 220 \pm 20%
 Sensitivity (dB) 100 \pm 3 at 1mW
 Frequency Range (Hz) 300-3400
 THD \leq 3%
 Operating Temperature ($^{\circ}$ C) -10-+40
 Weight (g) 5

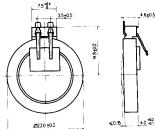
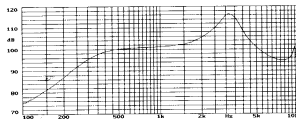

Type **SD-14**
 DC Resistance (Ω) 135 \pm 10%
 AC Impedance (Ω) 150 \pm 25%
 Sensitivity (dB) 110 \pm 3 at 1mW
 Frequency Range (Hz) 200-5000
 THD \leq 3%
 Operating Temperature ($^{\circ}$ C) -20-+50
 Weight (g) 22

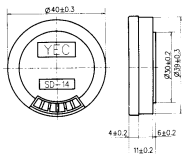
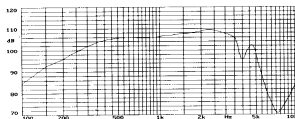

RECEIVER

Type **SD-15**
 DC Resistance (Ω) $135 \pm 10\%$
 AC Impedance (Ω) $150 \pm 20\%$
 Sensitivity (dB) 116 ± 2 at 1mW
 Frequency Range (Hz) 250-4000
 THD $< 5\%$
 Operating Temperature ($^{\circ}\text{C}$) -20~+50
 Weight (g) 67

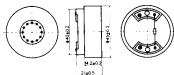
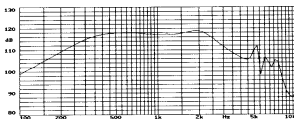

Type **SD-16**
 DC Resistance (Ω) 140 ± 30
 AC Impedance (Ω) $150 \pm 15\%$
 Sensitivity (dB) 116 ± 3 at 1Vrms
 Frequency Range (Hz) 300-3400
 THD $< 2\%$
 Operating Temperature ($^{\circ}\text{C}$) -40~+470
 Weight (g) 1.5

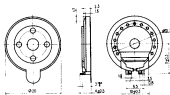
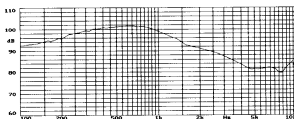

Type **SD-17**
 DC Resistance (Ω) $30 \pm 10\%$
 AC Impedance (Ω) $32 \pm 15\%$
 Sensitivity (dB) 88 ± 2 at 60mV
 Frequency Range (Hz) 300-3400
 THD $< 3\%$
 Operating Temperature ($^{\circ}\text{C}$) -20~+40
 Weight (g) 2

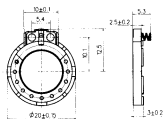
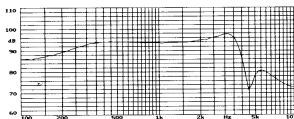

Type **SD-18**
 DC Resistance (Ω) 140 ± 30
 AC Impedance (Ω) 150 ± 30
 Sensitivity (dB) 86 ± 3 at 60mV
 Frequency Range (Hz) 300-3400
 THD $< 10\%$
 Operating Temperature ($^{\circ}\text{C}$) -40~+85
 Weight (g) 7

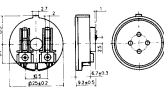
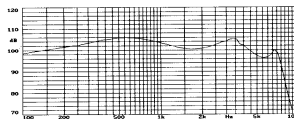

RECEIVER

Type **SD-19**
 DC Resistance (Ω) $135 \pm 10\%$
 AC Impedance (Ω) $150 \pm 20\%$
 Sensitivity (dB) 113 ± 3 at 1mW
 Frequency Range (Hz) 250-4000
 THD $< 5\%$
 Operating Temperature ($^{\circ}\text{C}$) -20-+55
 Weight (g) 32

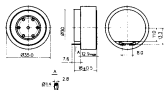
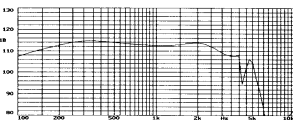

Type **SD-20**
 DC Resistance (Ω) 135 ± 15
 AC Impedance (Ω) 150 ± 30
 Sensitivity (dB) 96 ± 2 at 100mV
 Frequency Range (Hz) 200-4000
 THD $< 2\%$
 Operating Temperature ($^{\circ}\text{C}$) -10-+40
 Weight (g) 8

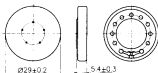
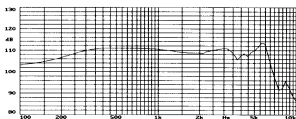

Type **SD-22**
 DC Resistance (Ω) 135 ± 15
 AC Impedance (Ω) 150 ± 30
 Sensitivity (dB) 98 ± 2 at 60mV
 Frequency Range (Hz) 200-4000
 THD $< 5\%$
 Operating Temperature ($^{\circ}\text{C}$) -20-+40
 Weight (g) 30

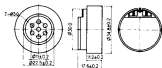
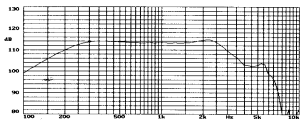

Type **SD-23**
 DC Resistance (Ω) $55 \pm 10\%$
 AC Impedance (Ω) $60 \pm 20\%$
 Sensitivity (dB) 110 ± 3 at 1mW
 Frequency Range (Hz) 300-3200
 THD $< 5\%$
 Operating Temperature ($^{\circ}\text{C}$) -25-+60
 Weight (g) 5

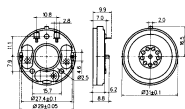
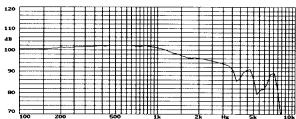

RECEIVER

Type	SD-24
DC Resistance (Ω)	130 \pm 10%
AC Impedance (Ω)	150 \pm 20%
Sensitivity (dB)	90 \pm 3 at 60mV
Frequency Range (Hz)	300-4000
THD	< 5%
Operating Temperature ($^{\circ}$ C)	-25-+40
Weight (g)	4.5

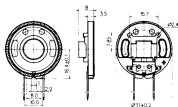
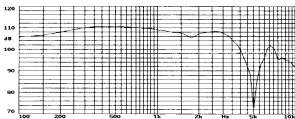

Type	SDB-1
DC Resistance (Ω)	135 \pm 10%
AC Impedance (Ω)	150 \pm 20%
Sensitivity (dB)	108 \pm 3 at 1mW
Frequency Range (Hz)	300-4000
THD	< 2%
Operating Temperature ($^{\circ}$ C)	-10-+40
Weight (g)	15

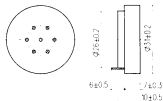
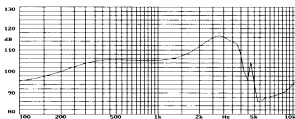

Type	SDB-2
DC Resistance (Ω)	30 \pm 10%
AC Impedance (Ω)	32 \pm 15%
Sensitivity (dB)	92 \pm 2 at 60mV
Frequency Range (Hz)	300-3400
THD	< 5%
Operating Temperature ($^{\circ}$ C)	-20-+40
Weight (g)	1

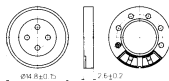
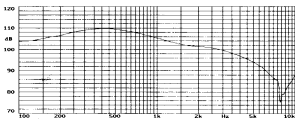

RECEIVER

Type	SYD01
Sensitivity (dB)	100-111 at 1Vrms
Capacitance (nF)	55-105
Max. Input (Vrms)	10
Frequency Range (Hz)	300-3400
THD	< 1.5%
Operating Temperature (°C)	-40-+85
Weight (g)	1.3

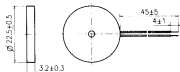
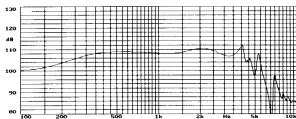

Type	SYJ01
Sensitivity (dB)	107.5±2.5 at 1Vrms
Capacitance (nF)	60±30%
Max. Input (Vrms)	5
Frequency Range (Hz)	300-3400
THD	< 1.5%
Operating Temperature (°C)	-40-+85
Weight (g)	1.3

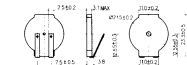
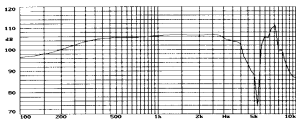

Type	SYK01
Sensitivity (dB)	102-110 at 1Vrms
Capacitance (nF)	35-65
Max. Input (Vrms)	5
Frequency Range (Hz)	300-3400
THD	< 2%
Operating Temperature (°C)	-30-+85
Weight (g)	0.5

