

Ceramic Resonator ZTB Series

Dimensions Tol: $\pm 0.3\text{mm}$ 190~1250 KHz

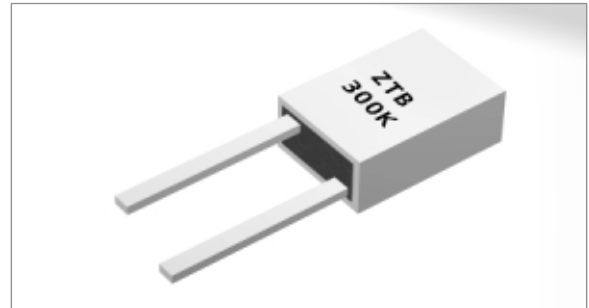
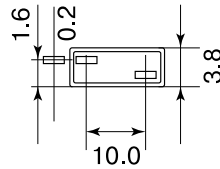
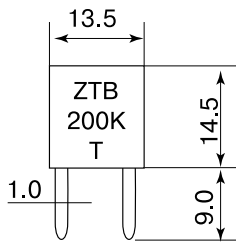

Principal Parameters

Model	Frequency Range (KHz)	Frequency Accuracy (25°C)(KHz)	Temperature Stability (-20°C~+80°C)	Age (Ten Years)	C ₁ (pF)	C ₂ (pF)
ZTB	190-249	(190~374) ± 1	0.3%	0.5%	330	470
	250-374	(375~800) ± 2			220	470
	375-429	8010~999) ± 4			120	470
	430-509	(1000~1250) $\pm 0.5\%$			100	100
	510-649				100	100
	650-767				100	100
	768-1250				100	100

Ceramic Resonator

Dimensions (mm)

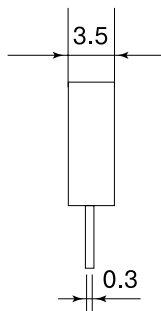
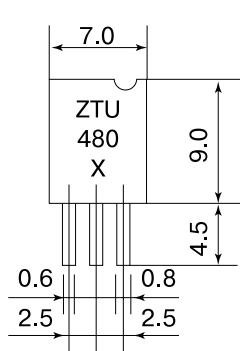

- 1: Input
- 2: Ground
- 3: Output

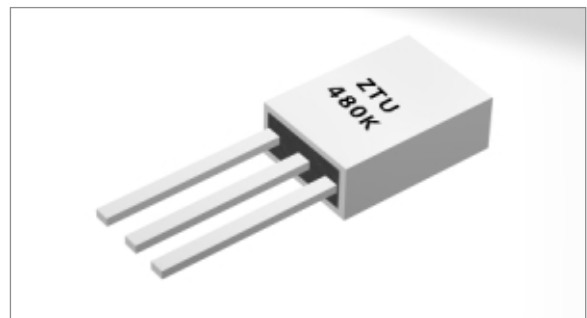

Principal Parameters

Model	Frequency Range Standart Frequency	Frequency Accuracy(KHz)	Oscillation Frequency Temperature Stability (-20°C~+80°C)
ZTU	450-500 455,480	± 2	$\pm 0.3\%$