

STK 105 °C

Features

- 105°C 2000 hours assured
- Vertical chip type miniaturized for 5.5 mm



Specifications

Item	Performance																									
Operating Temperature Range	-55 °C to +105 °C																									
Capacitance Tolerance	±20 % (at 120 Hz, 20 °C)																									
Leakage Current (at 20 °C)	I = 0.01 CV or 3 (µA) whichever is greater (After 2 minutes) Where, C = rated capacitance in µF, V = rated DC working voltage in V.																									
Dissipation Factor (tan δ at 120 Hz, 20 °C)	<table border="1"> <thead> <tr> <th>Rated Voltage</th> <th>6.3</th> <th>10</th> <th>16</th> <th>25</th> <th>35</th> <th>50</th> </tr> </thead> <tbody> <tr> <td>tan δ (max)</td> <td>0.30</td> <td>0.26</td> <td>0.22</td> <td>0.16</td> <td>0.13</td> <td>0.12</td> </tr> </tbody> </table>	Rated Voltage	6.3	10	16	25	35	50	tan δ (max)	0.30	0.26	0.22	0.16	0.13	0.12											
Rated Voltage	6.3	10	16	25	35	50																				
tan δ (max)	0.30	0.26	0.22	0.16	0.13	0.12																				
Low Temperature Characteristics (at 120 Hz)	Impedance ratio shall not exceed the values given in the table below <table border="1"> <thead> <tr> <th colspan="2">Rated Voltage</th> <th>6,3</th> <th>10</th> <th>16</th> <th>25</th> <th>35</th> <th>50</th> </tr> </thead> <tbody> <tr> <td rowspan="2">Impedance ratio</td> <td>Z(-25 °C)/Z(+20 °C)</td> <td>4</td> <td>3</td> <td>2</td> <td>2</td> <td>2</td> <td>2</td> </tr> <tr> <td>Z(-40 °C)/Z(+20 °C)</td> <td>8</td> <td>5</td> <td>4</td> <td>3</td> <td>3</td> <td>3</td> </tr> </tbody> </table>	Rated Voltage		6,3	10	16	25	35	50	Impedance ratio	Z(-25 °C)/Z(+20 °C)	4	3	2	2	2	2	Z(-40 °C)/Z(+20 °C)	8	5	4	3	3	3		
Rated Voltage		6,3	10	16	25	35	50																			
Impedance ratio	Z(-25 °C)/Z(+20 °C)	4	3	2	2	2	2																			
	Z(-40 °C)/Z(+20 °C)	8	5	4	3	3	3																			
Load Life Test	<table border="1"> <thead> <tr> <th>Test Time</th> <th>2000 hrs</th> </tr> </thead> <tbody> <tr> <td>Capacitance Change</td> <td>Within ± 20 % of initial value</td> </tr> <tr> <td>Dissipation Factor</td> <td>Less than 200 % of specified value</td> </tr> <tr> <td>Leakage Current</td> <td>Within specified value</td> </tr> </tbody> </table> <p>* The above specifications shall be satisfied when the capacitors are restored to 20 °C, after the rated voltage applied for 1000 hrs at 105 °C</p>	Test Time	2000 hrs	Capacitance Change	Within ± 20 % of initial value	Dissipation Factor	Less than 200 % of specified value	Leakage Current	Within specified value																	
Test Time	2000 hrs																									
Capacitance Change	Within ± 20 % of initial value																									
Dissipation Factor	Less than 200 % of specified value																									
Leakage Current	Within specified value																									
Shelf Life Test	<table border="1"> <thead> <tr> <th>Test Time</th> <th>1000 hrs</th> </tr> </thead> <tbody> <tr> <td>Capacitance Change</td> <td>Within ± 20 % of initial value</td> </tr> <tr> <td>Dissipation Factor</td> <td>Less than 200 % of specified value</td> </tr> <tr> <td>Leakage Current</td> <td>Within specified value</td> </tr> </tbody> </table> <p>*The above specifications shall be suitable when the capacitors are restored to 20 °C after exposing them for 1000 hrs at 105 °C without voltage applied.</p>	Test Time	1000 hrs	Capacitance Change	Within ± 20 % of initial value	Dissipation Factor	Less than 200 % of specified value	Leakage Current	Within specified value																	
Test Time	1000 hrs																									
Capacitance Change	Within ± 20 % of initial value																									
Dissipation Factor	Less than 200 % of specified value																									
Leakage Current	Within specified value																									
Ripple Current & Frequency Multipliers	<table border="1"> <thead> <tr> <th>V.DC (V)</th> <th colspan="4">Freq. (Hz)</th> </tr> <tr> <th></th> <th>50</th> <th>120</th> <th>1K</th> <th>10K up</th> </tr> </thead> <tbody> <tr> <td>Under 16</td> <td>0.8</td> <td>1.0</td> <td>1.15</td> <td>1.25</td> </tr> <tr> <td>25~35</td> <td>0.8</td> <td>1.0</td> <td>1.25</td> <td>1.40</td> </tr> <tr> <td>50</td> <td>0.8</td> <td>1.0</td> <td>1.35</td> <td>1.50</td> </tr> </tbody> </table>	V.DC (V)	Freq. (Hz)					50	120	1K	10K up	Under 16	0.8	1.0	1.15	1.25	25~35	0.8	1.0	1.25	1.40	50	0.8	1.0	1.35	1.50
V.DC (V)	Freq. (Hz)																									
	50	120	1K	10K up																						
Under 16	0.8	1.0	1.15	1.25																						
25~35	0.8	1.0	1.25	1.40																						
50	0.8	1.0	1.35	1.50																						
Ripple Current & Frequency Multipliers	<table border="1"> <thead> <tr> <th>Temperature (° C)</th> <th>Under 85</th> <th>105</th> </tr> </thead> <tbody> <tr> <td>Multiplier</td> <td>1.35</td> <td>1.00</td> </tr> </tbody> </table>	Temperature (° C)	Under 85	105	Multiplier	1.35	1.00																			
Temperature (° C)	Under 85	105																								
Multiplier	1.35	1.00																								
Standards	Satisfies Characteristic W of JIS C 5141																									

Diagram of Dimensions

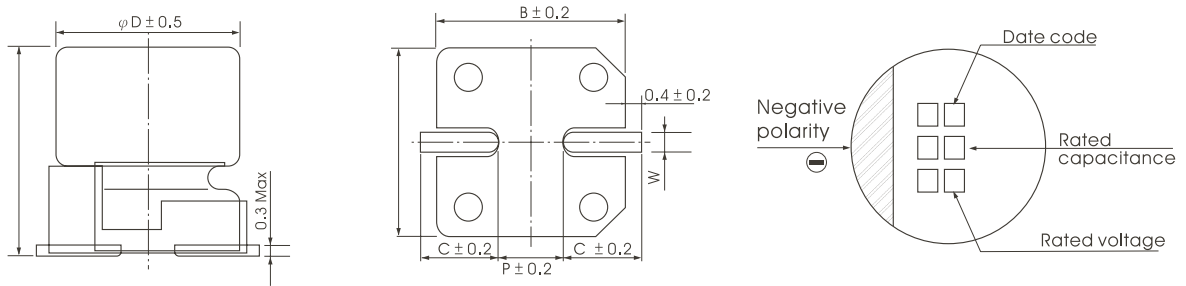

Unit: mm

φD	L	A	B	C	W	P
4	5.3 ± 0.2	4.3	4.3	2.0	0.5 to 0.8	1.0
5.3	5.3 ± 0.2	5.3	5.3	2.3	0.5 to 0.8	1.5
6.3	5.3 ± 0.2	6.6	6.6	2.7	0.5 to 0.8	2.0

Dimension & Permissible Ripple Current

Dimension: $\varphi D \times L$ (mm)

Ripple Current: A /rms at 120 Hz, 105 °C

V.DC Contents μF	6.3 V		10 V		16 V		25 V		35 V		50 V	
	$\varphi D \times L$	mA	$\varphi D \times L$	mA	$\varphi D \times L$	mA	$\varphi D \times L$	mA	$\varphi D \times L$	mA	$\varphi D \times L$	mA
0.1											4x5.3	2
0.22											4x5.3	3
0.33											4x5.3	4
0.47											4x5.3	5
1											4x5.3	7
2.2											4x5.3	10
3.3											4x5.3	12
4.7							4x5.3	12	4x5.3	14	5x5.3	17
10			4x5.3	15	4x5.3	16	5x5.3	21	5x5.3	23	6.3x5.3	26
22	4x5.3	21	5x5.3	25	5x5.3	28	6.3x5.3	36	6.3x5.3	50		
33	4x5.3	30	5x5.3	31	6.3x5.3	40	6.3x5.3	44				
47	5x5.3	36	6.3x5.3	43	6.3x5.3	47						
100	6.3x5.3	61										